

Test Leads

AL-38 SMD

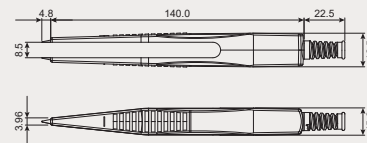

- Wire: UL 4330 / 22 AWG
- Length: 95cm
- Maximum Voltage: 300V
- Open clip distance: 8.5mm
- AL-38 SMD test probe is designed for measuring SMD components, such as SMD resistors, SMD capacitors, SMD diodes etc. with a general DMM.
- Easy to use.



AL-39

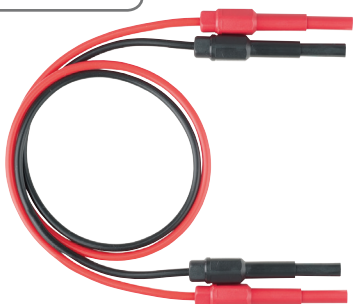

- Shrouded stacking banana plug on each end
- Silicone wire, 1.2m
- AL-39R Red**
- AL-39B Black**

AL-39H

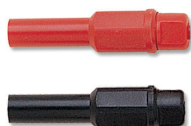
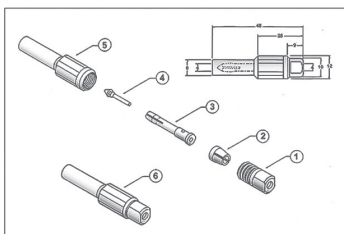

- Shrouded stacking plug
- AL-39HR Red**
- AL-39HB Black**

AL-42, AL-42S



- Terminal: 4mm banana plug
- **AL-42** wire: PVC UL1803
- **AL-42S** wire: silicon UL3239
- Length: 1500mm ± 30mm
- Rating:
EN 61010-031 CAT IV 600V 10A /
CAT III 1kV 10A

AL-4WER



- Used with 4-wire earth resistance testers
- Terminal: 4mm brass banana plug
- Wire: PVC
Outside diameter: 3.5mm
Braided copper wires: 65 / 0.127mm
Length: Black-3m, Blue-20m, Red-36m, Green-50m
- Auxiliary earth spikes: 45cm