

Telescopic Hot Sticks

SEW

The HS-180 Telescopic Hot Stick provides maximum flexibility and access for linesman needing to access electrical systems from a safe working distance. Its unique triangular design allows for easy operation without compromising strength or durability. The HS-180 has been designed to extend and retract into itself with integrated locking buttons. All sections are made from high grade electrical rated fiberglass.

FEATURES

- Strengthened joint design
- Triangular-shaped design keeps sections aligned during extension and retraction
- Push button release for stick extension and retraction
- Telescopic design allows for easy assembly, storage and transportation
- Lower push button fix position for better support of the telescopic hot stick
- Withstands voltage rating of 100kV from 30cm for 5 minutes
- Universal end fitting accepts a wide variety of standard attachments
- High-visibility yellow tip section
- Easy-to-replace sections
- Carrying bag included

APPLICATIONS

- Voltage detection
- Opening and closing switches
- Overhead switch operation
- Fuse replacement
- Cleaning electrical fittings
- Installation of temporary clamps
- Tree trimming

	HS-180-3	HS-180-4	HS-180-5	HS-180-6	HS-180-7	HS-180-8	HS-180-9
Sections	3	4	5	6	7	8	9
Extended length (m)	2.59	3.56	4.63	5.78	7.03	8.37	9.72
Retracted length (m)	1.18	1.32	1.46	1.60	1.74	1.89	1.94
Stick width (mm)	37.8	41.6	45.5	49.5	53.6	57.5	61.5
Weight (kg)	1.40	1.91	2.44	3.20	4.12	5.20	6.20

* NOTE: Dimension lengths are approximate and may have a variance of $\pm 0.05m$.

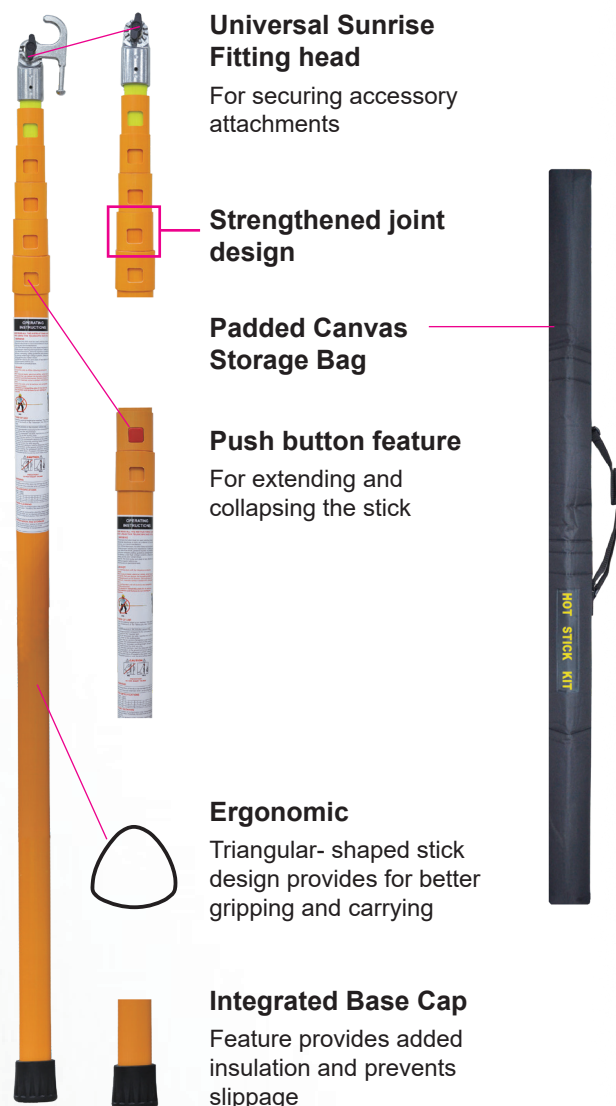

Accessories



HOK-HS166
Disconnect hook
(Included)



ADP-HS120
Fuse extractor head
(Optional)

STANDARD ELECTRIC WORKS CO., LTD.
www.sew.com.tw

5F., NO.105, JHONGCHENG RD., TUCHENG DIST.,
NEW TAIPEI CITY 23674, TAIWAN (R.O.C.)
TEL: 886-2-22681528
FAX: 886-2-22681529
e-mail: sales@sew.com.tw

Model
HS-180